

**NORIS STABIL VG HSSE**  
**Katalog-Nr. 6532 / 7532**

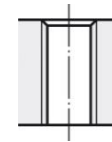

TIN Beschichtung

Schaft h9

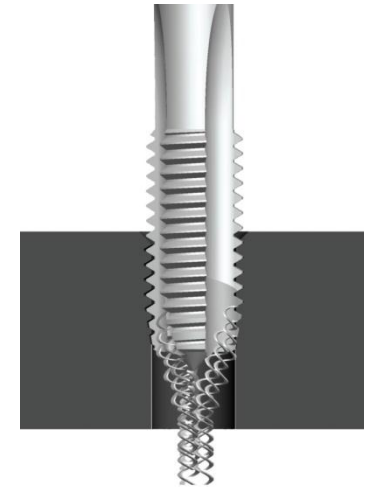

4xD

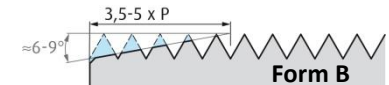

<b>A</b>	600 - 1400N/mm <sup>2</sup>	6-12 m/min	Emulsion / Öl
<b>R</b>	≤1100N/mm <sup>2</sup>	6-10 m/min	Emulsion / Öl